

28 Romford Road Epping NSW

1  1  1 

Welcome to this charming, well-furnished granny flat nestled in the popular residential suburb of Epping. Offering a peaceful and tranquil environment, this property is ideal for a small family seeking comfort and convenience. All electricity and water bills are included, ensuring a hassle-free living experience.

Price : \$460 pw

View : <https://www.icrealty.com.au/7962659>

Key Features:

- 1 bedroom, 1 bathroom with 1 car space
- Open space tidy kitchenette
- Large-sized bedroom
- Bathroom with shower area
- Within Epping Heights Public School catchment

Don't miss out on this opportunity to secure a cozy home in a sought-after location.



John Fan
(02) 89147918



William Song
(02) 89147918

Epping

28 Romford Road

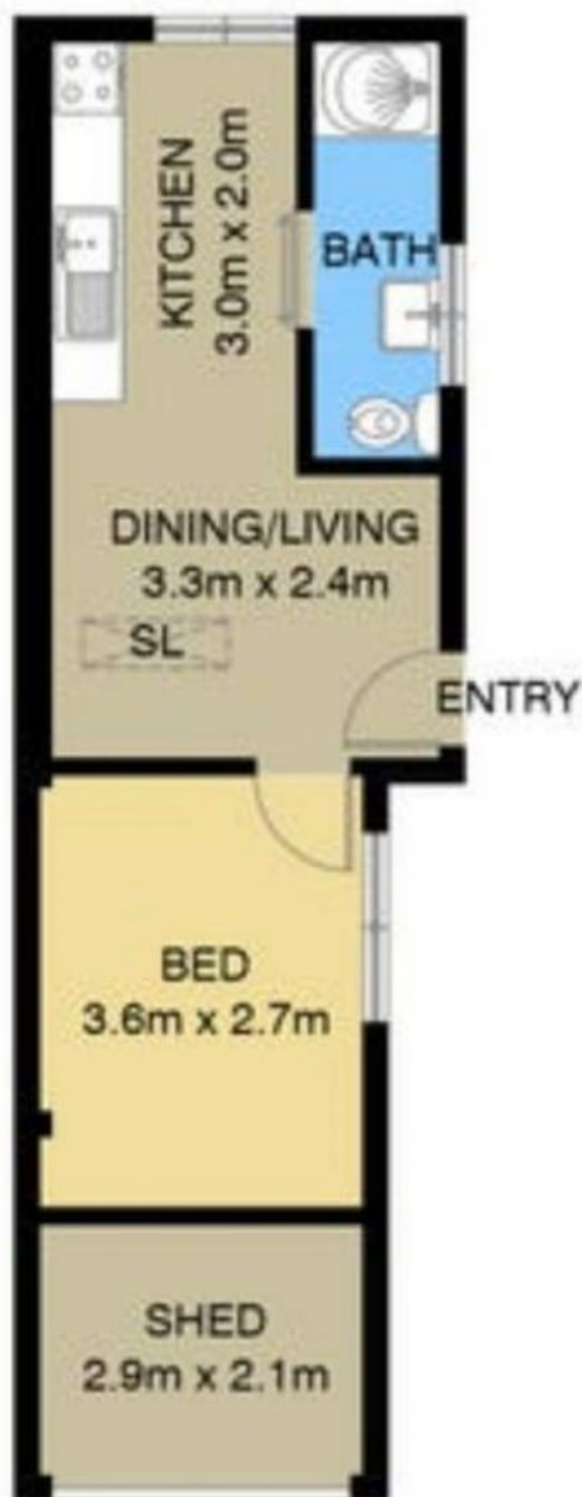

GRANNY FLAT